



Ficha técnica de produto

Technique product file / Ficha técnica de produto

Data: 20.04.2022

Versão: 2.0

IN.20.925

Sistemas de fecho /
Locking systems /
Sistemas de cierre

ET: 3536 / 2021

Documento confidencial / Confidential document / Documento confidencial © JNF 2022 www.jnf.pt

Descrição / Description / Descripción

Fechadura magnética para portas de correr /

Magnetic sliding door lock /

Cerradura magnética para puertas correderas

Versão / Version / Versión

2.0

Data / Date / Data

20.04.2022

Material / Material / Material

Aço Inox / Stainless Steel / Acero inoxidable - EN 1.4301

Acabamento / Finish / Acabado

Satinado / Satin / Satin

Acessórios / Accessories / Accesorios

4x Parafusos / 4x Screws / 4x Tornillos - 4.2 x 25 mm

1x Parafusos / 1x Screws / 1x Tornillos - M5 x 25 mm

1x Parafusos / 1x Screws / 1x Tornillos - M5 x 35 mm

Info. Embalagem / Package / Embalaje

Código de Barras /



Bar code /

Codigo de barras

5 602686 071296

Unidade / Unit / Unidad

1 Set

Peso / Weight / Peso

0,925 Kg.

Medidas / Dimensions / Dimensiones

235 x 170 x 55 mm

Embalagem / Package / Embalaje

CA1102

Outros acabamentos /

Other finishes / Otros acabados



.TB

TITANIUM BLACK



.TCH

TITANIUM CHOCOLATE



.TCO

TITANIUM COPPER



.TG

TITANIUM GOLD

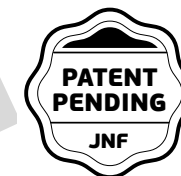

EN 12209 3 X 9 0 0 G 1 C G 0 0

T. (+351) 224 663 230 / F. (+351) 224 839 841 / e-mail - jnf@jnf.pt / www.jnf.pt



Ficha técnica de produto

Technique product file / Ficha técnica de produto

Data: 20.04.2022

Versão: 2.0

IN.20.925

Sistemas de fecho /

Locking systems /

Sistemas de cierre

ET: 3536 / 2021

Documento confidencial / Confidential document / Documento confidencial © JNF 2022 www.jnf.pt

Descrição / Description / Descripción

Fechadura magnética para portas de correr /

Magnetic sliding door lock /

Cerradura magnética para puertas correderas

Versão / Version / Versión

2.0

Data / Date / Data

20.04.2022

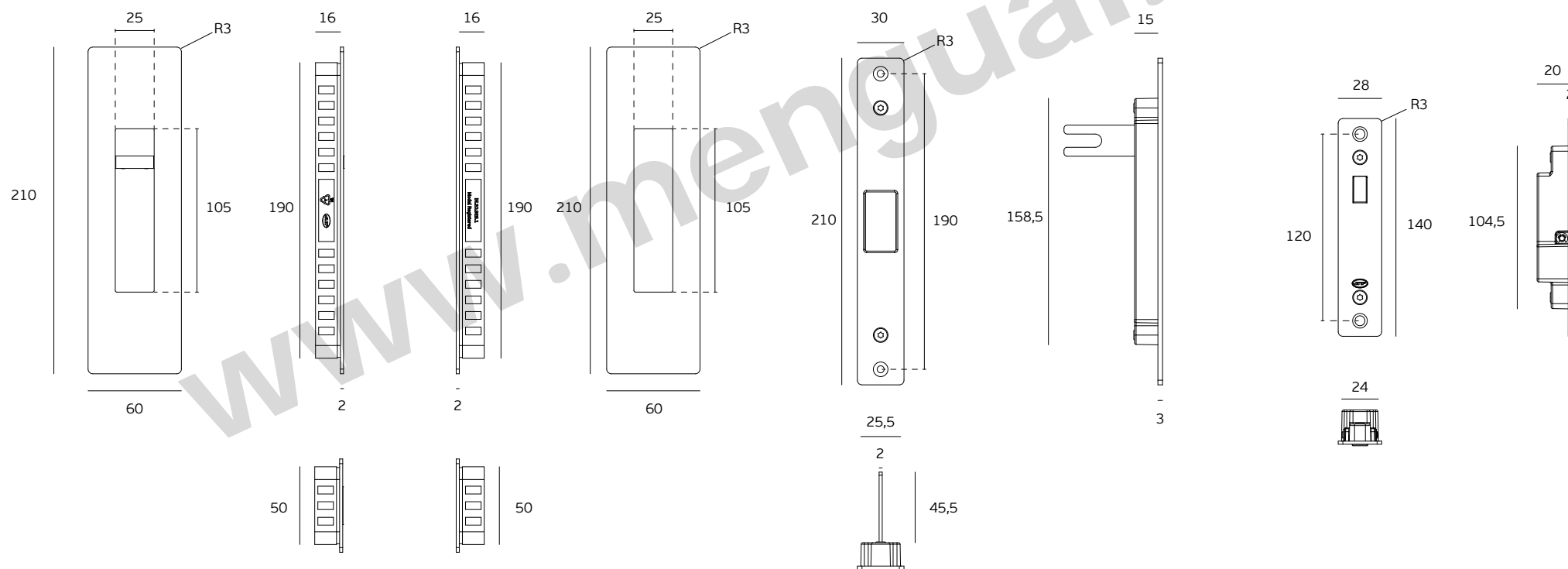



Ficha técnica de produto

Technique product file / Ficha técnica de produto

Data: 20.04.2022

Versão: 2.0

IN.20.925

Sistemas de fecho /

Locking systems /

Sistemas de cierre

ET: 3536 / 2021

Documento confidencial / Confidential document / Documento confidencial © JNF 2022 www.jnf.pt

Descrição / Description / Descripción

Fechadura magnética para portas de correr /

Magnetic sliding door lock /

Cerradura magnética para puertas correderas

Versão / Version / Versión

2.0

Data / Date / Data

20.04.2022

Espessura de porta /
Door thickness /
Espesor de la puerta

A	36-45	46-57
B	40-49	50-61

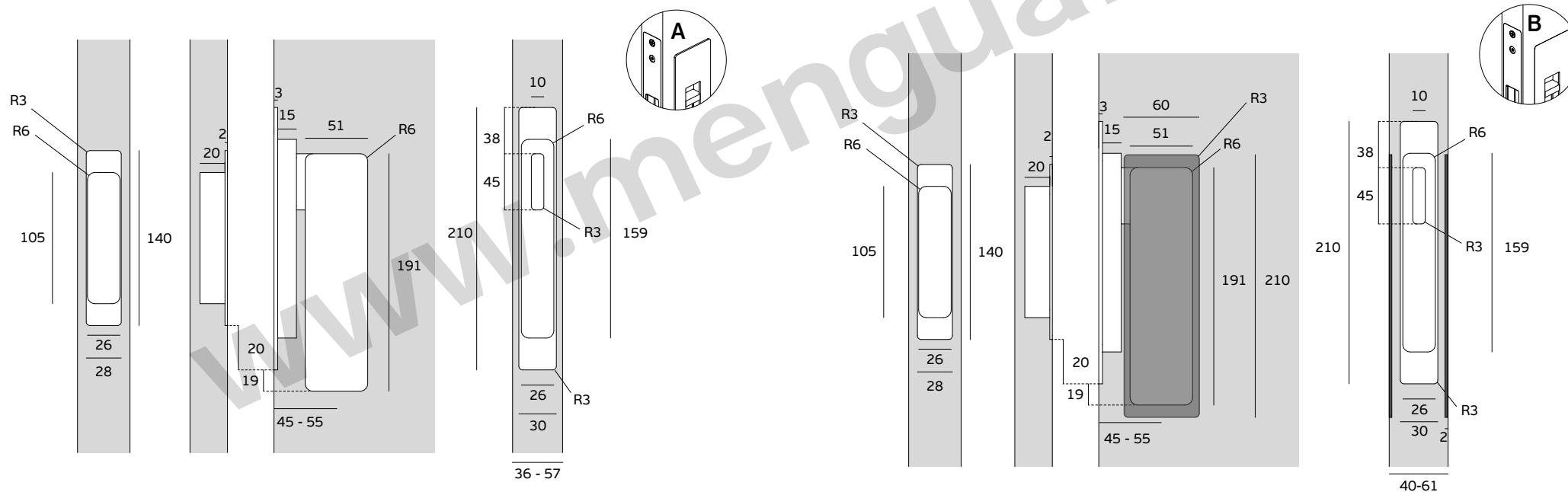

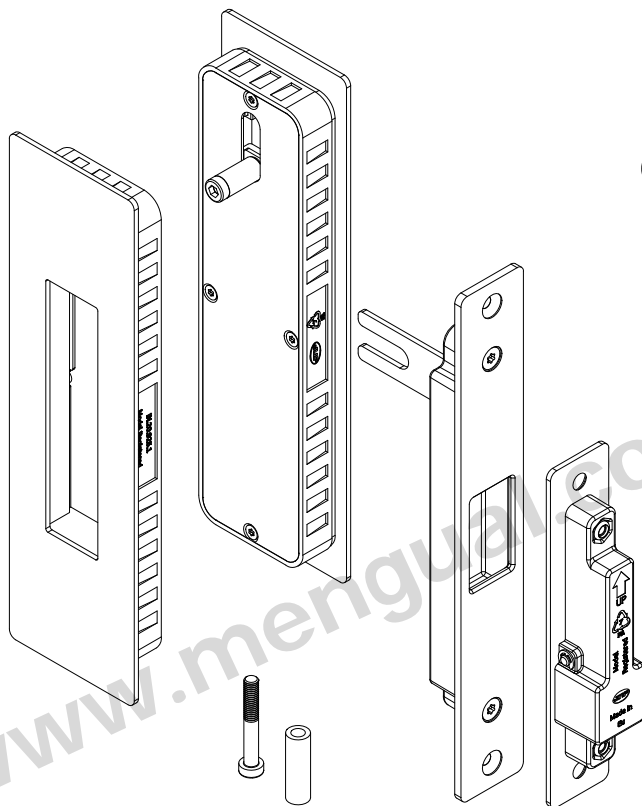

IN.20.925

PT EN ES

FECHADURA MAGNÉTICA PARA PORTA DE CORRER /
MAGNETIC LOCK FOR SLIDING DOOR /
CERRADURA MAGNÉTICA PARA PUERTAS CORREDERAS /

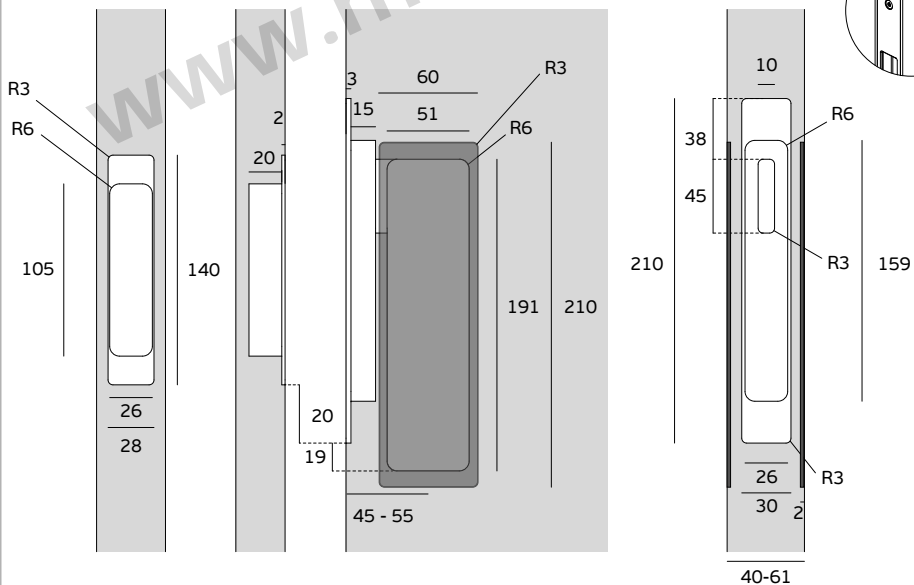
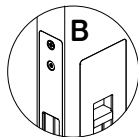
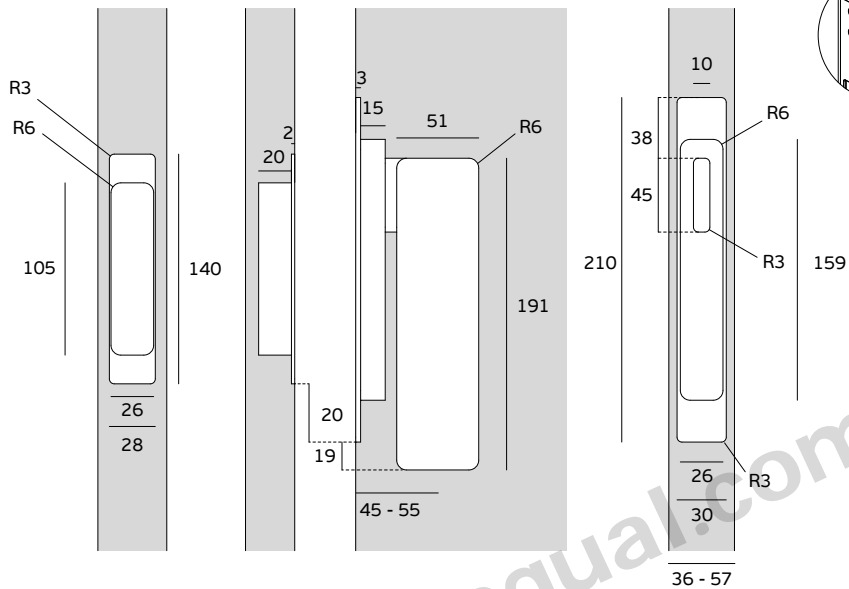
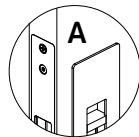

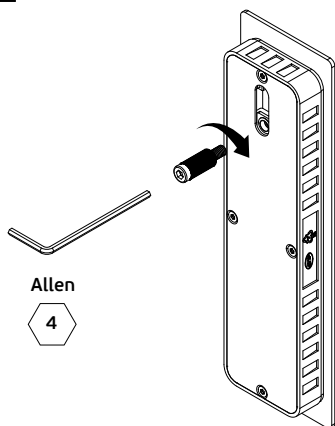

1



Allen

4

Espessura de porta /
Door thickness /
Espesor de la puerta

		
A	36-45	46-57
B	40-49	50-61

2

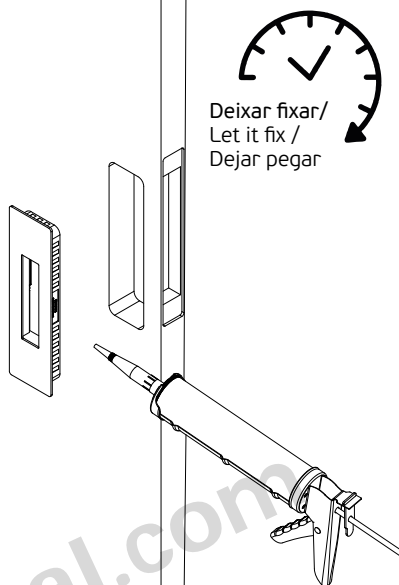

Deixar fixar/
Let it fix /
Dejar pegar

Seguir tempo de cura definido pelo fabricante /
Follow curing time defined by the manufacturer /
Siga el tiempo de curado definido por el fabricante

3

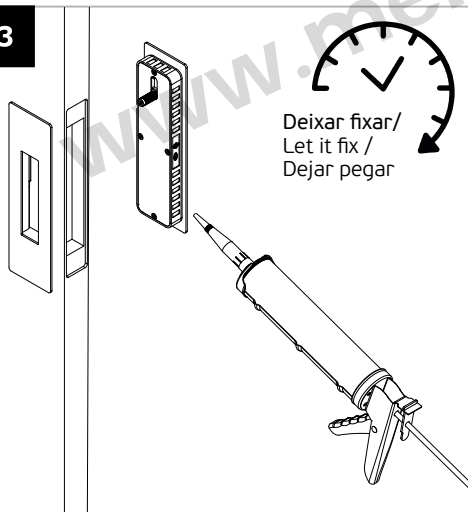

Deixar fixar/
Let it fix /
Dejar pegar

Seguir tempo de cura definido pelo fabricante /
Follow curing time defined by the manufacturer /
Siga el tiempo de curado definido por el fabricante

4

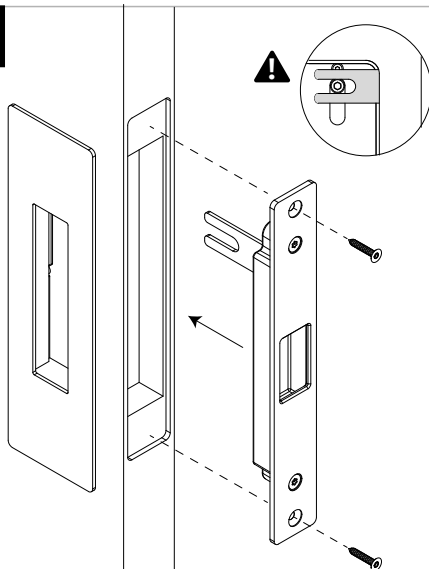

5

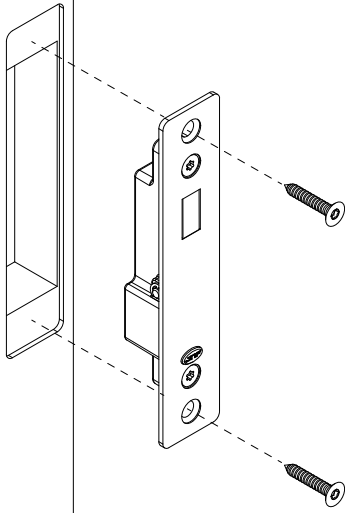

www.mengual.com

